

19 442 LS0 GROHE ONDUS THERMOSTAT WITH INTEGRATED 2-WAY DIVERTER FOR BATH OR SHOWER WITH MORE THAN ONE OUTLET



PRODUCT DESCRIPTION

- Colour: moon white
- set for final installation for
- GROHE Rapido T 35 500 000
- without concealed body
- temperature scale handle with GROHE SafeStop at 38°C
- Aquadimmer with multiple function
- shut off and flow control
- diverter for 2 outlets
- metal handles
- metal escutcheon
- escutcheon- and shaft-sealings
- covered fixing



19 442 LS0 GROHE ONDUS THERMOSTAT WITH INTEGRATED 2-WAY DIVERTER FOR BATH OR SHOWER WITH MORE THAN ONE OUTLET

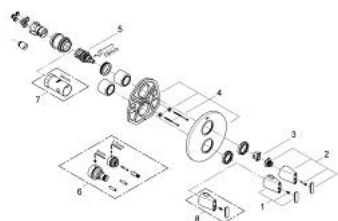

SPARE PARTS, February 2007 – now

- 1: Scale handle, metallic (Order-nr. 47795LS0)
- 2: Handle for shut-off valve (Order-nr. 47796LS0)
- 3: Stop ring (Order-nr. 10089000)
- 4: Escutcheon (Order-nr. 47797LS0)
- 5: Aquadimmer (Order-nr. 47364000)
- 6: Extension set 27.5 mm (Order-nr. 47781000)*
- 7: Socket spanner (Order-nr. 19332000)*
- 8: Scale handle, metallic (Order-nr. 47798LS0)*

*Special accessories