

19 611 IG0 CHIARA THERMOSTAT MIXER



PRODUCT DESCRIPTION

- Colour: chrome/gold
- set for final installation for 34 612
- without concealed body
- with escutcheon
- handle with economy button and individually adjustable economy stop
- temperature scale handle with GROHE SafeStop at 38°C
- individually limitable maximum temperature
- escutcheon- and shaft-sealings
- covered screws
- GROHE Long-Life finish

19 611 IG0 CHIARA THERMOSTAT MIXER

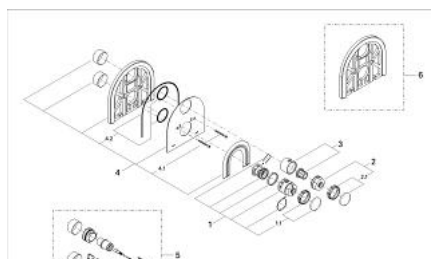

SPARE PARTS, January 1991 – now

- 1: Temperature scale handle (Order-nr. 47451PG0)
- 1.1: Cover cap (Order-nr. 47452PG0)
- 2: Handle for shut-off valve (Order-nr. 47453PG0)
- 2.1: Cover cap (Order-nr. 47452PG0)
- 3: Handle body (Order-nr. 47458P00)
- 4: Escutcheon 218 x 235 (Order-nr. 47463IG0)
- 4.1: Screws (Order-nr. 47460000)
- 4.2: Seal kit (Order-nr. 47471000)
- 5: Extension set 27.5 mm (Order-nr. 47461000)*
- 6: Compensation frame, 12 mm (Order-nr. 47464000)*

*Special accessories