

19 804 000 **COSTA CONCEALED VALVE EXPOSED PART**



PRODUCT DESCRIPTION

- Colour: chrome
- for GROHE concealed valves, 1/2", 3/4", 1"
- installation depth infinitely adjustable
- 20-80 mm
- escutcheon with screwable wall sealing
- Trecorn handle
- heat insulated plastic
- marking: blue/red
- GROHE Long-Life finish

19 804 000 **COSTA CONCEALED VALVE EXPOSED PART**

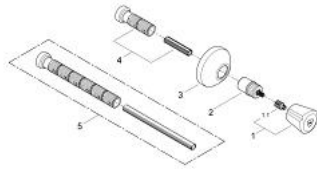

SPARE PARTS, October 2007 – now

1: ABS handle (Order-nr. 45144000)

1.1: Snap insert (Order-nr. 0538600M)

2: Extension for spindle (Order-nr. 45204000)

3: Escutcheon (Order-nr. 45219000)

4: Extension set, 80 mm (Order-nr. 45202000)

5: Extension set 200 mm (Order-nr. 45203000)*

*Special accessories