

19 917 DL0 CONCEALED VALVE EXPOSED PART

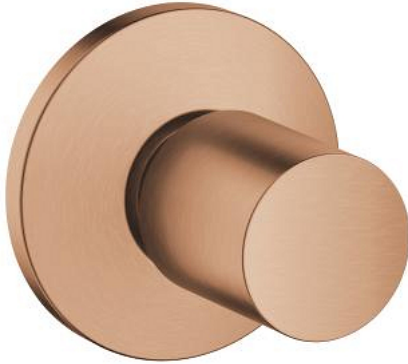

PRODUCT DESCRIPTION

- Colour: brushed warm sunset
- for GROHE concealed valves, 1/2", 3/4", 1"
- without concealed body
- adjustable installation depth 10 - 35 mm
- metal handle
- sliding escutcheon

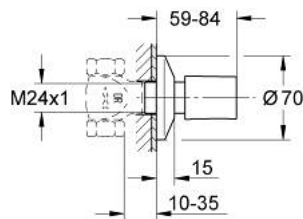

19 917 DL0 CONCEALED VALVE EXPOSED PART

SPARE PARTS, July 2023 – now

- 1: Snap insert (Order-nr. 0538600M)
- 2: sleeve (Order-nr. 06688DL0)
- 3: Extension for spindle (Order-nr. 45201000)
- 3.1: Clip (Order-nr. 0256900M)
- 4: escutcheon (Order-nr. 06386DL0)

