

- Colour: chrome
- Carbodur ceramic headparts 1/2", 180°
- non swivel spout with mousseur
- pressure-proof flexible connection hoses between spout and side valves
- union nut with 10.5 mm drilling
- pop-up waste set 1 1/4"
- GROHE Long-Life finish

20 147 000 **ARIA THREE-HOLE BASIN MIXER 1/2"**

SPARE PARTS, June 2006 – now

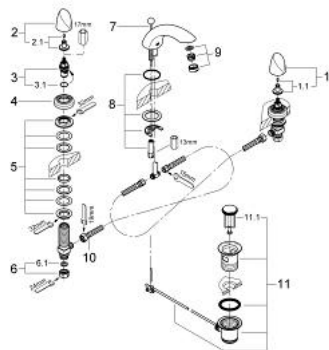

- 1: Handle (Order-nr. 45980000)
- 1.1: Replacement handle connection kit (Order-nr. 45605000)
- 2: Handle (Order-nr. 45972000)
- 2.1: Replacement handle connection kit (Order-nr. 45605000)
- 3: Ceramic headpart 1/2" (Order-nr. 45346000)
- 3.1: O-ring Ø 18.2 x Ø 1.7 (Order-nr. 0392400M)
- 4: Escutcheon (Order-nr. 04698000)
- 5: Counter screws M28 x 1.5 (Order-nr. 45025000)
- 6: Coupling nut 1/2" (Order-nr. 1290100M)
- 6.1: Fibre seal Ø 18,5 x Ø 12 x 2 (Order-nr. 0138900M)
- 7: Pop-up rod (Order-nr. 07511000)
- 8: Shank mounting kit (Order-nr. 46122000)
- 9: Mousseur (Order-nr. 13929000)
- 10: Flexible hose (Order-nr. 45442000)
- 11: Waste fitting (Order-nr. 28915000)
- 11.1: Plug (Order-nr. 45210000)