

20 405 001 **COSTA S PILLAR TAP 1/2"**

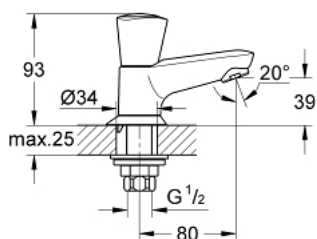

**PRODUCT DESCRIPTION**

- Colour: chrome
- metal handle
- heat insulated
- screwable
- marking: blue
- Carbodur headpart
- cast spout with mousseur
- union nut 1/2" x 10.5 mm
- GROHE Long-Life finish



## 20 405 001 **COSTA S PILLAR TAP 1/2"**

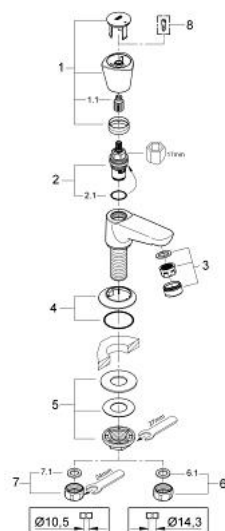

### **SPARE PARTS**, June 2007 – now

- 1: Handle (Order-nr. 45995000)
- 1.1: Snap insert (Order-nr. 0538600M)
- 2: Ceramic headpart 1/2" (Order-nr. 45346000)
- 2.1: O-ring Ø 18.2 x Ø 1.7 (Order-nr. 0392400M)
- 3: Mousseur (Order-nr. 13929000)
- 4: Escutcheon (Order-nr. 45996000)
- 5: Shank fastening assembly 1/2" (Order-nr. 45000000)
- 6: Coupling nut 1/2" x 14.5 mm (Order-nr. 1290200M)
- 6.1: Fibre seal Ø 18,5 x Ø 12 x 2 (Order-nr. 0138900M)
- 7: Coupling nut 1/2" (Order-nr. 1290100M)
- 7.1: Fibre seal Ø 18,5 x Ø 12 x 2 (Order-nr. 0138900M)
- 8: Screw for Costa/Avina products (Order-nr. 48013000)\*

\*Special accessories