

20 422 000 BAULOOK PILLAR TAP 1/2" XS-SIZE

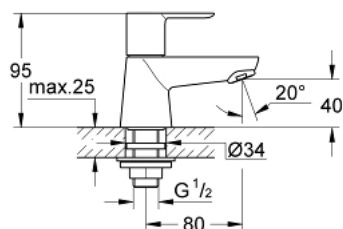

PRODUCT DESCRIPTION

- Colour: chrome
- single hole installation
- metal lever
- ceramic headpart 1/2", 90°
- GROHE Long-Life finish
- GROHE Water Saving - Less water, perfect flow
- maximum flow rate (at 3 bar): 5 l/min
- fixation nut G 1/2"



20 422 000 **BAULOOK PILLAR TAP 1/2" XS-SIZE**

SPARE PARTS, September 2012 – now

1: Lever (Order-nr. 48027000)

2: Ceramic headpart 1/2" (Order-nr. 45882000)

2.1: O-ring Ø 18.2 x Ø 1.7 (Order-nr. 0392400M)

3: Mousseur (Order-nr. 13952000)

4: Shank mounting kit (Order-nr. 45004000)

