

## 20 620 IG0 CHIARA THREE-HOLE BASIN MIXER 1/2"

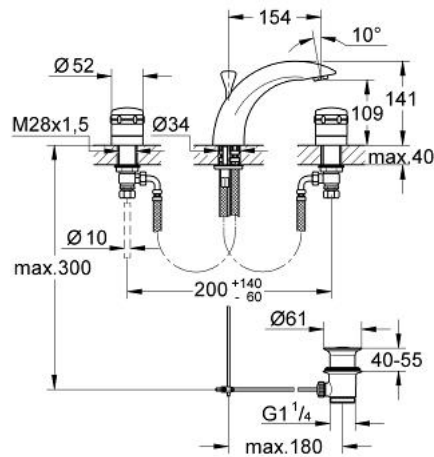

### PRODUCT DESCRIPTION

- Colour: chrome/gold
- Carbodur ceramic headparts 1/2", 180°
- non swivel spout with mousseur
- pressure-proof, flexible connection hoses
- union nut with 10.5 mm drilling
- pop-up waste set 1 1/4"
- GROHE Long-Life finish

## 20 620 IG0 CHIARA THREE-HOLE BASIN MIXER 1/2"

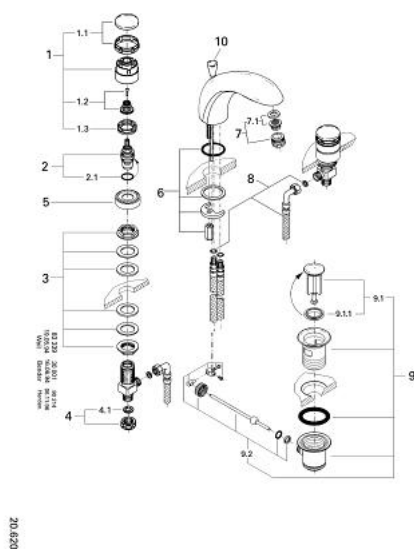

### SPARE PARTS, January 1991 – now

- 1: Handle (Chiara) 1/2", neutral (Order-nr. 45493PG0)
- 1.1: Cover cap (Order-nr. 47452PG0)
- 1.2: Replacement handle connection kit (Order-nr. 45186000)
- 1.2.1: O-ring Ø 18.2 x Ø 1.7 (Order-nr. 0392400M)
- 1.3: Support ring (Order-nr. 03070000)
- 2: Ceramic headpart 1/2" (Order-nr. 45346000)
- 2.1: O-ring Ø 18.2 x Ø 1.7 (Order-nr. 0392400M)
- 3: Counter screws M28 x 1.5 (Order-nr. 45025000)
- 4: Coupling nut 1/2" (Order-nr. 1290100M)
- 4.1: Fibre seal Ø 18,5 x Ø 12 x 2 (Order-nr. 0138900M)
- 5: Escutcheon (Order-nr. 45494000)
- 6: Shank mounting kit (Order-nr. 45226000)
- 7: Mousseur (Order-nr. 13929G00)
- 7.1: Replacement flow control M22x1 and M24x1 (Order-nr. 45002000)
- 8: Flexible hose (Order-nr. 45461000)
- 9: Waste set 1 1/4" (Order-nr. 28910IG0)
- 9.1: Plug (Order-nr. 07182G00)
- 9.2: Eccentric rod (Order-nr. 07052000)
- 10: Pop-up rod (Order-nr. 45495G00)