

21 003 000 **SUPRA ONE-HOLE BASIN MIXER, 1/2"**

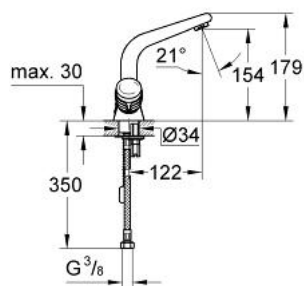

**PRODUCT DESCRIPTION**

- Colour: chrome
- Carbodur ceramic headparts 1/2", 180°
- heat-insulated, screwed union
- handles
- swivel cast spout with mousseur
- retractable chain
- flexible connection hoses
- GROHE Long-Life finish



## 21 003 000 SUPRA ONE-HOLE BASIN MIXER, 1/2"

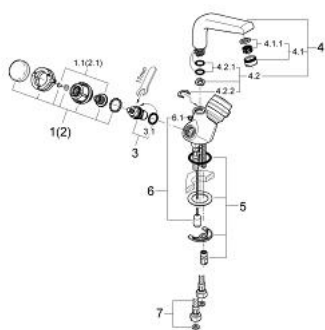

### SPARE PARTS, January 2002 – now

- 1: Supra handle, blue (Order-nr. 45355000)
- 1.1: Replacement handle connection kit (Order-nr. 45186000)
- 1.1.1: O-ring Ø 18.2 x Ø 1.7 (Order-nr. 0392400M)
- 2: Supra handle, blue (Order-nr. 45354000)
- 2.1: Replacement handle connection kit (Order-nr. 45186000)
- 3: Ceramic headpart 1/2" (Order-nr. 45346000)
- 3.1: O-ring Ø 18.2 x Ø 1.7 (Order-nr. 0392400M)
- 4: Cast swivel spout (Order-nr. 13406000)
- 4.1: Mousseur (Order-nr. 13929000)
- 4.1.1: Replacement flow control M22x1 and M24x1 (Order-nr. 45002000)
- 4.2: Spout connection set (Order-nr. 45013000)
- 4.2.1: Sealing washer (Order-nr. 0128500M)
- 4.2.2: Safety ring (Order-nr. 0485300M)
- 5: Shank mounting kit (Order-nr. 45226000)
- 6: Chain (Order-nr. 06815000)
- 6.1: Chain support (Order-nr. 0116100M)
- 7: Flexible connection hose, 470 (Order-nr. 45484000)