

21 610 IG0 **FLORIDA ONE-HOLE BASIN MIXER, 1/2"**

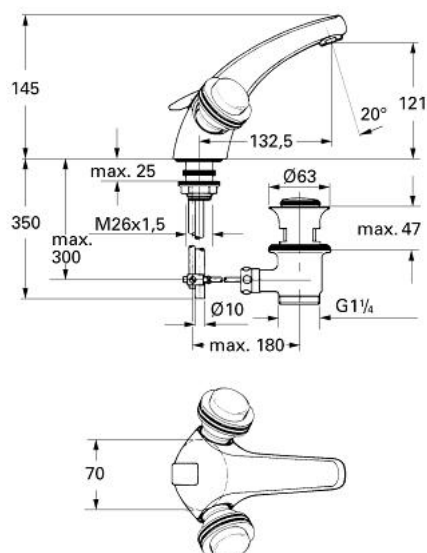

PRODUCT DESCRIPTION

- Colour: chrome/gold
- Carbodur ceramic headparts 1/2", 180°
- fastened cast spout with mousseur
- pop-up waste set 1 1/4"
- without handles
- for handles, see product no.18 956/18 996/18 997
- GROHE Long-Life finish



21 610 IG0 **FLORIDA ONE-HOLE BASIN MIXER, 1/2"**

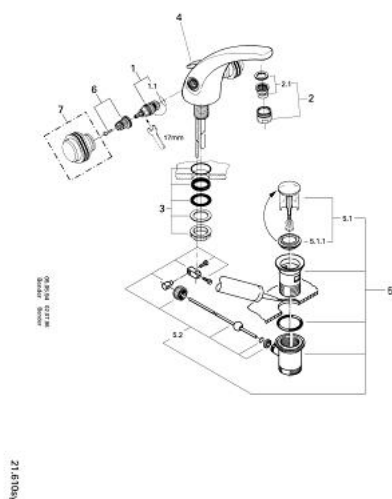

SPARE PARTS, January 1984 – now

- 1: Ceramic headpart 1/2" (Order-nr. 45346000)
- 1.1: O-ring Ø 18.2 x Ø 1.7 (Order-nr. 0392400M)
- 2: Mousseur (Order-nr. 13929G00)
- 2.1: Replacement flow control M22x1 and M24x1 (Order-nr. 45002000)
- 3: Shank fastening assembly M26 x 1.5 (Order-nr. 45012000)
- 4: Pop-up rod (Order-nr. 45177IG0)
- 5: Waste set 1 1/4" (Order-nr. 28910IG0)
- 5.1: Plug (Order-nr. 07182G00)
- 5.2: Eccentric rod (Order-nr. 07052000)
- 6: Replacement handle connection kit (Order-nr. 45186000)
- 6.1: O-ring Ø 18.2 x Ø 1.7 (Order-nr. 0392400M)
- 7: Handle (Order-nr. 45180000)*
- 8: Florida handle 115 (Order-nr. 45230IG0)*
- 9: Florida handle (500) (Order-nr. 45206IG0)*
- 10: Dorina handle (510) (Order-nr. 45207000)*

*Special accessories