

23 202 000 **WAVE COSMOPOLITAN SINGLE-LEVER BASIN MIXER 1/2"** **S-SIZE**

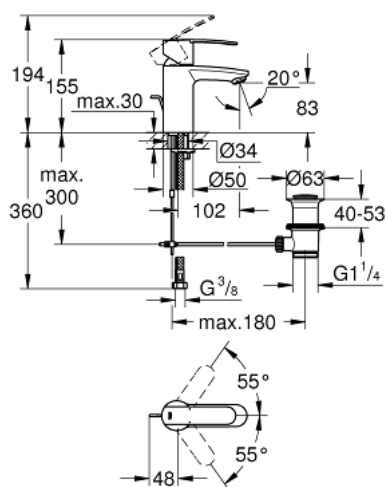

PRODUCT DESCRIPTION

- Colour: chrome
- single hole installation
- metal lever
- GROHE SilkMove 35 mm ceramic cartridge
- adjustable flow rate limiter
- adjustable minimum flow rate approx. 2.5 l/min
- GROHE Long-Life finish
- GROHE Water Saving SpeedClean mousseur 5.7 l/min
- pop-up waste set 1 1/4"
- flexible connection hoses
- GROHE FastFixation installation system with centering support
- optional temperature limiter ref. no. 46 375
- GROHE QuickTool included



23 202 000 **WAVE COSMOPOLITAN SINGLE-LEVER BASIN MIXER 1/2"** **S-SIZE**

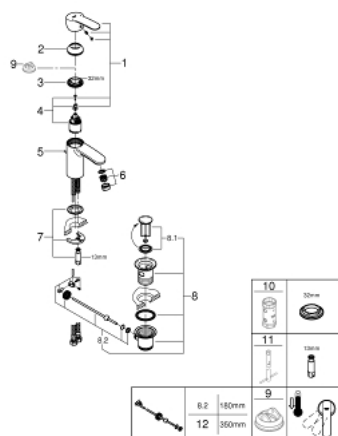

SPARE PARTS, February 2011 – now

- 1: Lever (Order-nr. 46748000)
 - 2: Cap (Order-nr. 46492000)
 - 3: Screw coupling (Order-nr. 46460000)
 - 4: Cartridge (Order-nr. 46374000)
 - 5: Pop-up rod (Order-nr. 46739000)
 - 6: Laminar flow straightener (Order-nr. 13955000)
 - 6: Mousseur (Order-nr. 48159000)
 - 7: Shank mounting kit (Order-nr. 46671000)
 - 8: Waste set 1 1/4" (Order-nr. 28910000)
 - 8.1: Plug (Order-nr. 07182000)
 - 8.2: Eccentric rod (Order-nr. 07052000)
 - 9: Temperature limiter (Order-nr. 46375000)*
 - 10: Socket spanner (Order-nr. 19332000)*
 - 11: Mounting wrench (Order-nr. 19017000)*
 - 12: Eccentric rod (Order-nr. 07341000)*
- *Special accessories