

## 23 216 000 **WAVE COSMOPOLITAN SINGLE-LEVER BASIN MIXER 1/2"**

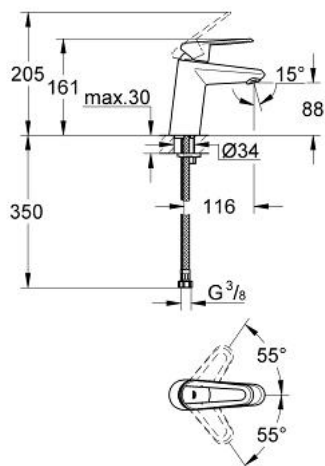

### PRODUCT DESCRIPTION

- Colour: chrome
- single hole installation
- metal lever
- GROHE SilkMove 35 mm ceramic cartridge
- temperature limiter
- GROHE Long-Life finish
- GROHE Water Saving SpeedClean mousseur 5.7 l/min
- adjustable flow rate limiter
- adjustable minimum flow rate approx. 2.5 l/min
- smooth body
- flexible connection hoses
- GROHE FastFixation installation system with centering support
- noise classification I in accordance with DIN 4109



## 23 216 000 **WAVE COSMOPOLITAN SINGLE-LEVER BASIN MIXER 1/2"**

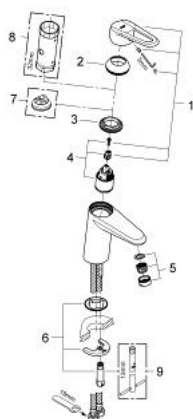

### **SPARE PARTS**, February 2011 – now

- 1: Lever (Order-nr. 46799000)
- 2: Cap (Order-nr. 46492000)
- 3: Screw coupling (Order-nr. 46460000)
- 4: Cartridge (Order-nr. 46374000)
- 5: Mousseur (Order-nr. 48159000)
- 6: Shank mounting kit (Order-nr. 46671000)
- 7: Temperature limiter (Order-nr. 46375000)\*
- 8: Socket spanner (Order-nr. 19332000)\*
- 9: Mounting wrench (Order-nr. 19017000)\*
- \*Special accessories