

24 407 000 **SENTOSA SINGLE-HOLE BIDET MIXER 1/2"**

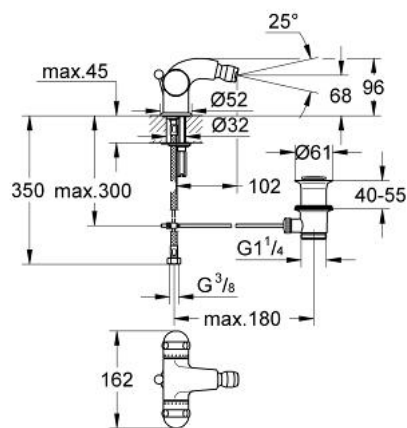

PRODUCT DESCRIPTION

- Colour: chrome
- Carbodur ceramic headparts 1/2", 180°
- ball-joint mousseur
- pop-up waste set 1 1/4"
- flexible connection hoses
- rapid installation system
- GROHE Long-Life finish



24 407 000 SENTOSA SINGLE-HOLE BIDET MIXER 1/2"

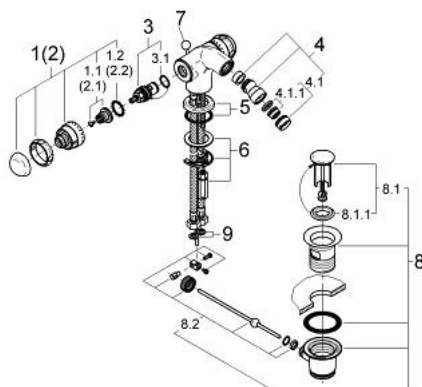

SPARE PARTS, January 1993 – now

- 1: Handle 1/2", red (Sentosa) (Order-nr. 45539IP0)
- 1.1: Replacement handle connection kit (Order-nr. 45186000)
- 1.1.1: O-ring Ø 18.2 x Ø 1.7 (Order-nr. 0392400M)
- 1.2: Guide ring (Order-nr. 0202100M)
- 2: Handle 1/2" (Sentosa) (Order-nr. 45538IP0)
- 2.1: Replacement handle connection kit (Order-nr. 45186000)
- 2.2: Guide ring (Order-nr. 0202100M)
- 3: Ceramic headpart 1/2" (Order-nr. 45346000)
- 3.1: O-ring Ø 18.2 x Ø 1.7 (Order-nr. 0392400M)
- 4: Ball-joint aerator (Order-nr. 13921000)
- 4.1: Mousseur (Order-nr. 13929000)
- 4.1.1: Replacement flow control M22x1 and M24x1 (Order-nr. 45002000)
- 5: Escutcheon (Order-nr. 45540000)
- 6: Shank mounting kit (Order-nr. 46249000)
- 7: Pop-up rod (Order-nr. 45541P00)
- 8: Waste set 1 1/4" (Order-nr. 28910000)
- 8.1: Plug (Order-nr. 07182000)
- 8.2: Eccentric rod (Order-nr. 07052000)
- 9: Fibre seal Ø 14.5 x Ø 8 x 2 (Order-nr. 0138300M)