

25 344 000 **ATLANTA BATH MIXER 1/2"**

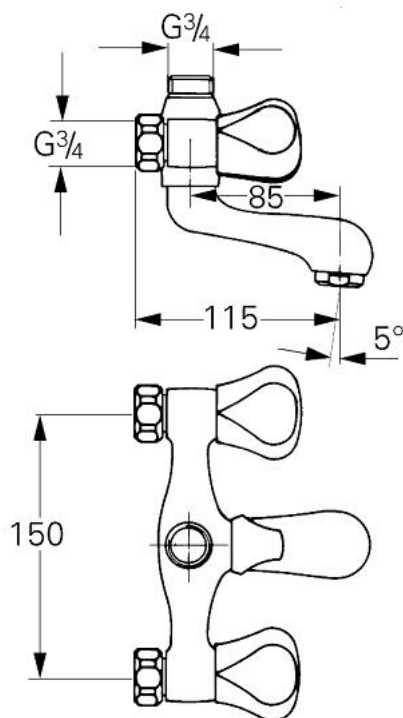

PRODUCT DESCRIPTION

- Colour: chrome
- wall mounted
- Treflor handles
- diverter bath/shower
- mousseur
- shower connection 1/2"
- without connection unions
- GROHE Long-Life finish



25 344 000 ATLANTA BATH MIXER 1/2"

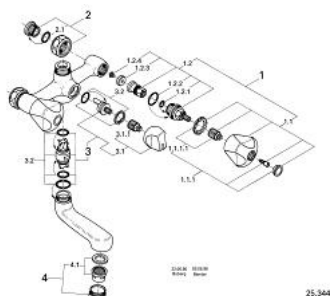

SPARE PARTS, January 1981 – now

- 1: Headpart 1/2" (Order-nr. 11086000)
- 1.1: Treflor handle 1/2" (Order-nr. 45124000)
- 1.1.1: Handle fixation (Order-nr. 45123000)
- 1.1.1.1: Snap insert (Order-nr. 0538600M)
- 1.2: Headpart 1/2" (Order-nr. 07146000)
- 1.2.1: Sealing washer Ø 6 x Ø 2 (Order-nr. 0128300M)
- 1.2.2: O-ring Ø 18.2 x Ø 1.7 (Order-nr. 0392400M)
- 1.2.3: Seal (Order-nr. 0529100M)
- 2: Screw connection 1/2" (Order-nr. 45044000)
- 2.1: Seal Ø 15 x Ø 2 (Order-nr. 0311900M)
- 3: Diverter (Order-nr. 45128000)
- 3.1: Snap insert (Order-nr. 0538600M)
- 4: Mousseur (Order-nr. 13927000)
- 4.1: Replacement flow control M28x1 (Order-nr. 45029000)