

25 426 000 **ATLANTA BATH MIXER**



**PRODUCT DESCRIPTION**

- Colour: chrome
- wall mounted
- Treflor handles
- Carbodur ceramic headparts 1/2", 180°
- automatic diverter: bath/shower
- mousseur
- shower connection 1/2"
- without connection unions
- GROHE Long-Life finish

## 25 426 000 ATLANTA BATH MIXER

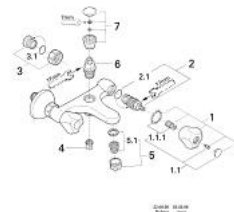

25-426

### SPARE PARTS, January 1988 – now

- 1: Treflor handle 1/2" (Order-nr. 45124000)
- 1.1: Handle fixation (Order-nr. 45123000)
- 1.1.1: Snap insert (Order-nr. 0538600M)
- 2: Ceramic headpart 1/2" (Order-nr. 45346000)
- 2.1: O-ring Ø 18.2 x Ø 1.7 (Order-nr. 0392400M)
- 3: Screw connection 1/2" (Order-nr. 45044000)
- 3.1: Seal Ø 15 x Ø 2 (Order-nr. 0311900M)
- 4: Non-return valve (Order-nr. 08565000)
- 5: Mousseur (Order-nr. 13927000)
- 5.1: Replacement flow control M28x1 (Order-nr. 45029000)
- 6: Diverter (Order-nr. 08915000)
- 7: Diverter knob (Order-nr. 07526000)