

- Colour: chrome
- Trecorn handle
- chrome plated plastic
- heat-insulated, screwed union
- automatic diverter: bath/shower
- cast spout with mousseur
- without connection unions
- GROHE Long-Life finish

25 453 000 BATH MIXER 1/2"

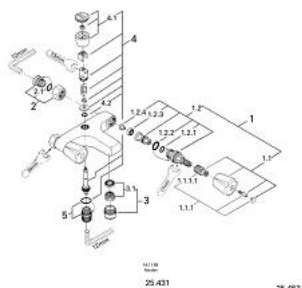

SPARE PARTS, January 1988 – now

- 1: Headpart 1/2" (Order-nr. 45534000)
- 1.1: ABS handle 1/2" (Order-nr. 45970000)
 - 1.1.1: Snap insert (Order-nr. 0538600M)
- 1.2: Headpart 1/2" (Order-nr. 07146000)
 - 1.2.1: Sealing washer Ø 6 x Ø 2 (Order-nr. 0128300M)
 - 1.2.2: O-ring Ø 18.2 x Ø 1.7 (Order-nr. 0392400M)
 - 1.2.3: Seal (Order-nr. 0529100M)
- 2: Screw connection 1/2" (Order-nr. 45044000)
 - 2.1: Seal Ø 15 x Ø 2 (Order-nr. 0311900M)
- 3: Mousseur (Order-nr. 13927000)
 - 3.1: Replacement flow control M28x1 (Order-nr. 45029000)
- 4: Diverter (Order-nr. 46056000)
 - 4.1: Diverter knob (Order-nr. 07526000)
 - 4.2: Sealing washer Ø 6 x Ø 2 (Order-nr. 0128300M)
 - 4.2: O-ring Ø 6 x Ø 2 (Order-nr. 0881100M)
- 5: Shower nipple (Order-nr. 45104000)