

25 561 000 **TALIA BATH MIXER 1/2"**

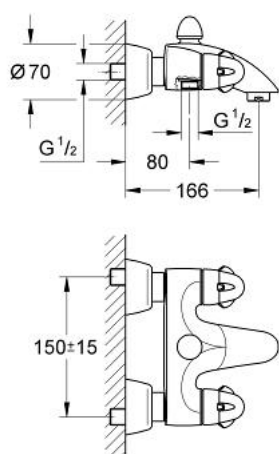

PRODUCT DESCRIPTION

- Colour: chrome
- wall mounted
- Carbodur ceramic headparts 1/2", 180°
- automatic diverter: bath/shower
- integrated non-return valves
- mousseur
- S-unions
- GROHE Long-Life finish

25 561 000 **TALIA BATH MIXER 1/2"**

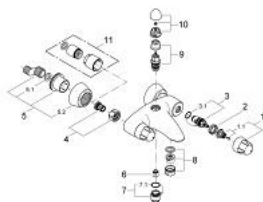

SPARE PARTS, July 2007 – now

- 1: Handle (Order-nr. 45357IP0)
 - 1.1: Replacement handle connection kit (Order-nr. 45186000)
 - 1.1.1: O-ring Ø 18.2 x Ø 1.7 (Order-nr. 0392400M)
 - 2: Support ring (Order-nr. 03070000)
 - 3: Ceramic headpart 1/2" (Order-nr. 45346000)
 - 3.1: O-ring Ø 18.2 x Ø 1.7 (Order-nr. 0392400M)
 - 4: Screw connection (Order-nr. 45582000)
 - 5: S-union (Order-nr. 12058000)
 - 5.1: Seal (Order-nr. 0138600M)
 - 5.2: Covering escutcheon (Order-nr. 45545000)
 - 6: Non-return valve (Order-nr. 08565000)
 - 7: Outlet nipple (Order-nr. 45546000)
 - 7.1: Sealing washer Ø 21 x Ø 2 (Order-nr. 0599900M)
 - 8: Mousseur (Order-nr. 13927000)
 - 9: Diverter (Order-nr. 08915000)
 - 10: Diverter knob (Order-nr. 45547000)
 - 11: Extension set, 30 mm (Order-nr. 46238000)*
- *Special accessories