

25 612 000 **FLORIDA BATH MIXER 1/2"**

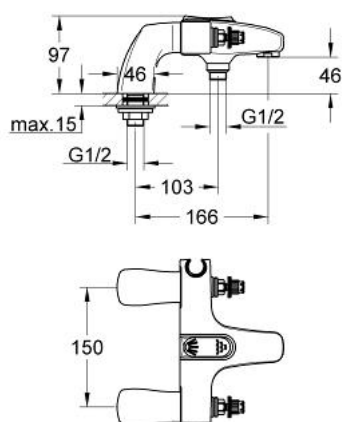

PRODUCT DESCRIPTION

- Colour: chrome
- pillar installation
- Carbodur ceramic headparts 1/2", 180°
- automatic push button diverter
- bath/shower
- integrated handspray holder
- mousseur
- pillar unions
- without handles
- attention
- not suitable for the installation of tile banks
- shower outlet 1/2"
- GROHE Long-Life finish

25 612 000 FLORIDA BATH MIXER 1/2"

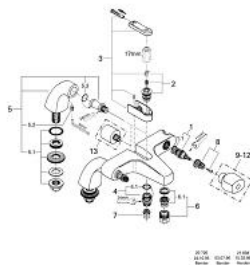

25-612

SPARE PARTS, January 1984 – now

- 1: Ceramic headpart 1/2" (Order-nr. 45346000)
- 1.1: O-ring Ø 18.2 x Ø 1.7 (Order-nr. 0392400M)
- 2: Diverter (Order-nr. 45187000)
- 3: Pressure disc (Order-nr. 45188000)
- 4: Outlet nipple (Order-nr. 45487000)
- 4.1: Sealing washer Ø 21 x Ø 2 (Order-nr. 0599900M)
- 5: Pillar union 1/2" (Order-nr. 12084000)
- 5.1: Shank fastening assembly 1/2" (Order-nr. 45000000)
- 5.2: Thread pin (Order-nr. 0587800M)
- 5.3: O-ring Ø 18 x Ø 2.5 (Order-nr. 0128100M)
- 6: Mousseur (Order-nr. 13927000)
- 6.1: Replacement flow control M28x1 (Order-nr. 45029000)
- 7: Non-return valve (Order-nr. 08565000)
- 8: Replacement handle connection kit (Order-nr. 45186000)
- 8.1: O-ring Ø 18.2 x Ø 1.7 (Order-nr. 0392400M)
- 9: Handle (Order-nr. 45180000)*
- 10: Florida handle 115 (Order-nr. 45230000)*
- 11: Florida handle (500) (Order-nr. 45206000)*
- 12: Dorina handle (510) (Order-nr. 45207000)*
- 13: Extension set 1/2", 30 mm (Order-nr. 45238000)*

*Special accessories