

26 016 001 **COSTA L SOLID BASIN MIXER 1/2"**

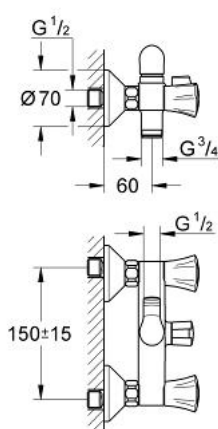

**PRODUCT DESCRIPTION**

- Colour: chrome
- wall mounted
- metal handles
- heat insulated
- screwable
- GROHE Long-Life headpart
- diverter bath/shower
- S-unions
- elbow union 3/4" x 1/2" (12 001)
- GROHE Long-Life finish

26 016 001 **COSTA L SOLID BASIN MIXER 1/2"**

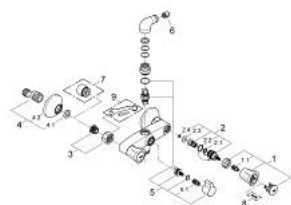

**SPARE PARTS**, October 2009 – now

- 1: Handle (Order-nr. 45994000)
  - 1.1: Snap insert (Order-nr. 0538600M)
  - 2: Headpart 1/2" (Order-nr. 07146000)
  - 2.1: Sealing washer Ø 6 x Ø 2 (Order-nr. 0128300M)
  - 2.2: O-ring Ø 18.2 x Ø 1.7 (Order-nr. 0392400M)
  - 2.3: Seal (Order-nr. 0529100M)
  - 3: Screw connection 1/2" (Order-nr. 45044000)
  - 4: S-union (Order-nr. 12075000)
  - 4.1: Seal (Order-nr. 0138600M)
  - 4.2: Escutcheon (Order-nr. 0221000M)
  - 5: Replacement kit for rotary valve (Order-nr. 48006000)
  - 5.1: Snap insert (Order-nr. 0538600M)
  - 6: Non-return valve (Order-nr. 08565000)
  - 7: Extension 3/4", 20 mm (Order-nr. 0713000M)\*
  - 8: Screw for Costa/Avina products (Order-nr. 48013000)\*
  - 9: Special spanner (Order-nr. 19377000)\*
- \*Special accessories