

26 347 000 **SENTOSA SHOWER MIXER 1/2"**

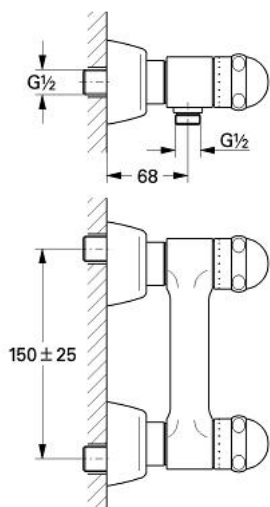

PRODUCT DESCRIPTION

- Colour: chrome
- wall mounted
- Carbodur ceramic headparts 1/2", 180°
- shower outlet 1/2"
- integrated non-return valve
- S-unions
- without shower set
- GROHE Long-Life finish

26 347 000 SENTOSA SHOWER MIXER 1/2"

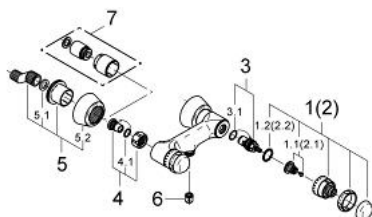

SPARE PARTS, January 1993 – now

- 1: Handle 1/2" (Sentosa) (Order-nr. 45538IP0)
 - 1.1: Replacement handle connection kit (Order-nr. 45186000)
 - 1.1.1: O-ring Ø 18.2 x Ø 1.7 (Order-nr. 0392400M)
 - 1.2: Guide ring (Order-nr. 0202100M)
 - 2: Handle 1/2", red (Sentosa) (Order-nr. 45539IP0)
 - 2.1: Replacement handle connection kit (Order-nr. 45186000)
 - 2.2: Guide ring (Order-nr. 0202100M)
 - 3: Ceramic headpart 1/2" (Order-nr. 45346000)
 - 3.1: O-ring Ø 18.2 x Ø 1.7 (Order-nr. 0392400M)
 - 4: Screw connection (Order-nr. 45544000)
 - 4.1: Seal Ø 15 x Ø 2 (Order-nr. 0311900M)
 - 5: S-union (Order-nr. 12058000)
 - 5.1: Seal (Order-nr. 0138600M)
 - 5.2: Covering escutcheon (Order-nr. 45545000)
 - 6: Non-return valve (Order-nr. 08565000)
 - 7: Extension set, 30 mm (Order-nr. 46238000)*
- *Special accessories