

26 403 002 VITALIO JOY SYSTEM 260 SHOWER SYSTEM WITH THERMOSTATIC MIXER FOR WALL MOUNTING

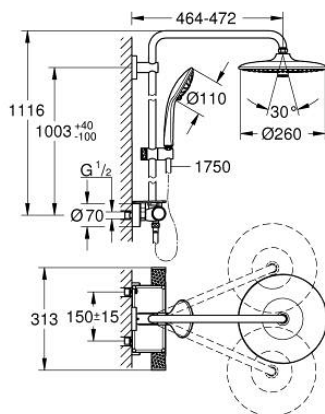

PRODUCT DESCRIPTION (1/2)

- Colour: chrome
- consisting of:
 - horizontal swivable 450 mm shower arm
 - exposed Precision thermostat with Aquadimmer function
 - allows change between:
 - head shower Vitalio Joy 260 (26 462)
 - 3 spray patterns:
 - Rain, SmartRain, Jet
 - flow rate Rain (at 3 bar): 13.5 l/min
 - with ball joint
 - rotation angle $\pm 15^\circ$
 - hand shower Vitalio Joy 110 Massage (27 319)
 - 3 spray patterns:
 - Rain, Massage, SmartRain
 - maximum flow rate (at 3 bar): 9.5 l/min
 - adjustable in height with gliding element
 - shower hose VitalioFlex Silver 1.750 mm, $\frac{1}{2}$ " x $\frac{1}{2}$ " (27 506)
- GROHE EasyReach tray
- GROHE TurboStat compact cartridge with wax thermoelement
- GROHE Water Saving - Less water, perfect flow
- GROHE SafeStop safety button at 38°C
- GROHE SafeStop Plus optional temperature limiter at 43°C included
- GROHE CoolTouch no risk of scalding
- GROHE ProGrip with knurl structure
- GROHE DreamSpray perfect spray pattern
- GROHE Long-Life finish
- GROHE SprayDimmer (stepless flow rate reduction)
- GROHE FastFixation upper bracket adjustable
- Inner WaterGuide for a longer life
- SpeedClean anti-limescale system
- TwistStop to prevent hose from twisting
- suitable for instantaneous heaters from 18 kW/h
- minimum flow rate 7 l/min

Pure Freude
an Wasser



26 403 002 **VITALIO JOY SYSTEM 260 SHOWER SYSTEM WITH THERMOSTATIC MIXER FOR WALL MOUNTING**

PRODUCT DESCRIPTION (2/2)

- GROHE QuickSpanner included in chrome variant only
- Consumer edition

26 403 002 VITALIO JOY SYSTEM 260 SHOWER SYSTEM WITH THERMOSTATIC MIXER FOR WALL MOUNTING

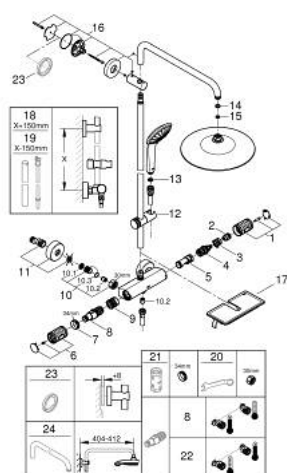

SPARE PARTS, January 2020 – now

- 1: Shut-off handle (Order-nr. 49162000)
- 2: Stop ring (Order-nr. 47986000)
- 3: Stop ring (Order-nr. 47965000)
- 4: Aquadimmer (Order-nr. 47364000)
- 5: Water flow (Order-nr. 47887000)
- 6: Shut-off handle (Order-nr. 49160000)
- 7: Fitting ring (Order-nr. 47743000)
- 8: Thermostatic compact cartridge 1/2" (Order-nr. 47439000)
- 9: Race (Order-nr. 47975000)
- 10: Non-return valve (Order-nr. 47189000)
- 10.1: Dirt strainer (Order-nr. 0726400M)
- 10.2: Non-return valve (Order-nr. 08565000)
- 10.3: O-ring $\varnothing 17 \times \varnothing 2$ (Order-nr. 0305500M)
- 11: S-union (Order-nr. 12662000)
- 12: Glide element (Order-nr. 48424000)
- 13: Dirt strainer (Order-nr. 0700200M)
- 14: Fibre seal $\varnothing 18,5 \times \varnothing 12 \times 2$ (Order-nr. 0138900M)
- 15: Dirt strainer (Order-nr. 48007000)
- 16: Shower rail holder (Order-nr. 48279000)
- 17: GROHE EasyReach tray (Order-nr. 26362LN1)
- 18: Shower system pipe for retrofitting (Order-nr. 48514000)*
- 19: Shower system pipe for retrofitting (Order-nr. 48515000)*
- 20: Special spanner (Order-nr. 19377000)*
- 21: Socket spanner (Order-nr. 19332000)*
- 22: GROHE TurboStat cartridge 1/2" (Order-nr. 47175000)*
- 23: Compensation disc (Order-nr. 27180000)*
- 24: Shower arm for shower systems (Order-nr. 14047000)*

*Special accessories