

26 788 001 **COSTA S SOLID BASIN MIXER**

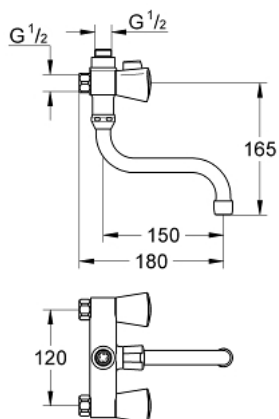

**PRODUCT DESCRIPTION**

- Colour: chrome
- 50 mm extension
- wall mounted
- metal handles
- heat insulated
- screwable
- Carbodur headpart
- diverter
- without connection unions
- swivel tubular spout
- centre distance 120 mm
- GROHE Long-Life finish



## 26 788 001 **COSTA S SOLID BASIN MIXER**

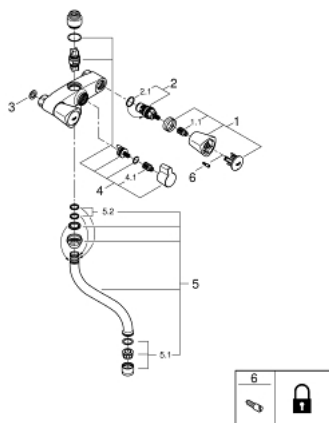

### **SPARE PARTS**, February 2008 – now

- 1: Handle (Order-nr. 45995000)
- 1.1: Snap insert (Order-nr. 0538600M)
- 2: Ceramic headpart (Order-nr. 45142000)
- 2.1: O-ring Ø 18.2 x Ø 1.7 (Order-nr. 0392400M)
- 3: Fibre seal Ø 18,5 x Ø 12 x 2 (Order-nr. 0138900M)
- 4: Replacement kit for rotary valve (Order-nr. 48006000)
- 4.1: Snap insert (Order-nr. 0538600M)
- 5: S spout (Order-nr. 13005000)
- 5.1: Mousseur (Order-nr. 13928000)
- 5.2: Sealing washer (Order-nr. 0128500M)
- 6: Screw for Costa/Avina products (Order-nr. 48013000)\*

\*Special accessories