

27 475 000 EUPHORIA SYSTEM 180 SHOWER SYSTEM WITH BATH THERMOSTAT FOR WALL MOUNTING



PRODUCT DESCRIPTION

- Colour: chrome
- consisting of:
 - horizontal swivable 450 mm shower arm
 - exposed thermostat with Aquadimmer function
 - allows change between:
 - head shower Euphoria Cosmopolitan (27 492 000)
 - chrome plated spray plate
 - spray pattern: Rain
 - with ball joint
 - rotation angle $\pm 15^\circ$
- bath inlet
- separate diverter for hand shower Euphoria 110 Massage (27 239 000)
- adjustable in height with gliding element
- Silverflex shower hose 1750 mm (28 388)
- GROHE Water Saving 9,5 l/min flow limiter
- GROHE TurboStat compact cartridge with wax thermoelement
- GROHE DreamSpray perfect spray pattern
- GROHE Long-Life finish
- SpeedClean anti-limescale system
- Inner WaterGuide for a longer life
- TwistStop to prevent hose from twisting
- suitable for instantaneous heaters from 18 kW/h
- minimum flow rate 7 l/min



27 475 000 EUPHORIA SYSTEM 180 SHOWER SYSTEM WITH BATH THERMOSTAT FOR WALL MOUNTING

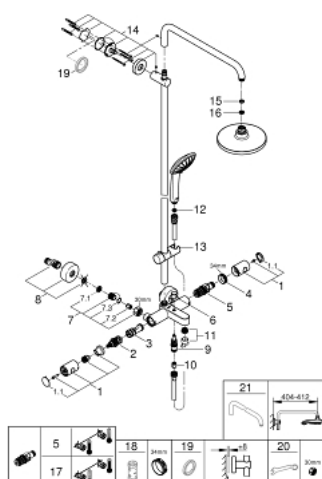

SPARE PARTS, July 2017 – now

- 1: Metal handle 1/2" (Order-nr. 47984000)
- 1.1: Cover cap (Order-nr. 6458500M)
- 2: Aquadimmer (Order-nr. 47364000)
- 3: Water flow (Order-nr. 47887000)
- 4: Fitting ring (Order-nr. 47743000)
- 5: Thermostatic compact cartridge 1/2" (Order-nr. 47439000)
- 6: Diverter knob (Order-nr. 65648000)
- 7: Non-return valve (Order-nr. 47189000)
- 7.1: Dirt strainer (Order-nr. 0726400M)
- 7.2: Non-return valve (Order-nr. 08565000)
- 7.3: O-ring $\varnothing 17 \times \varnothing 2$ (Order-nr. 0305500M)
- 8: S-union (Order-nr. 12662000)
- 9: Diverter (Order-nr. 65655000)
- 10: Non-return valve (Order-nr. 08565000)
- 11: Mousseur (Order-nr. 13926000)
- 12: Dirt strainer (Order-nr. 0700200M)
- 13: Glide element (Order-nr. 12140000)
- 14: Shower rail holder (Order-nr. 48279000)
- 15: Fibre seal $\varnothing 18,5 \times \varnothing 12 \times 2$ (Order-nr. 0138900M)
- 16: Dirt strainer (Order-nr. 48007000)
- 17: GROHE TurboStat cartridge 1/2" (Order-nr. 47175000)*
- 18: Socket spanner (Order-nr. 19332000)*
- 19: Compensation disc (Order-nr. 27180000)*
- 20: Special spanner (Order-nr. 19377000)*
- 21: Shower arm for shower systems (Order-nr. 14047000)*

*Special accessories