

## 28 964 000 RELEXA 100 FIVE SHOWER RAIL SET 5 SPRAYS

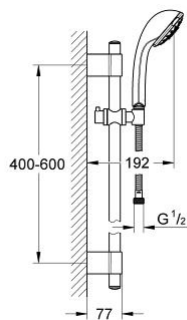

### PRODUCT DESCRIPTION

- Colour: chrome
- consisting of:
- shower rail, 600 mm (28 797)
- GROHE FastFixation Plus adjustable distance between brackets for adaption to existing drilling holes
- hand shower Relexa Five (28 796)
- Rotaflex TwistStop shower hose 1750 mm 1/2" x 1/2" (28 410)
- TwistStop to prevent hose from twisting
- GROHE Long-Life finish
- attention: old product



## 28 964 000 RELEXA 100 FIVE SHOWER RAIL SET 5 SPRAYS

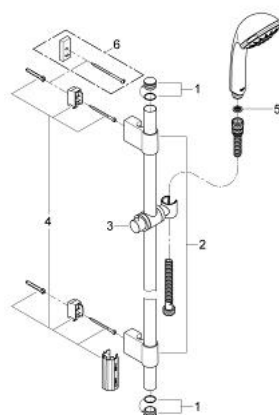

### SPARE PARTS, October 2009 – now

- 1: Cover cap (Order-nr. 45922000)
- 2: Shower rail holder (Order-nr. 6424500M)
- 3: Glide element (Order-nr. 06765000)
- 4: Fixing set (Order-nr. 48010000)
- 5: Dirt strainer (Order-nr. 0700200M)
- 6: Compensation disc (Order-nr. 45914XE0)\*

\*Special accessories