

30 039 DC0 GROHE RED DUO FAUCET AND COMBI-BOILER (8 LITER)

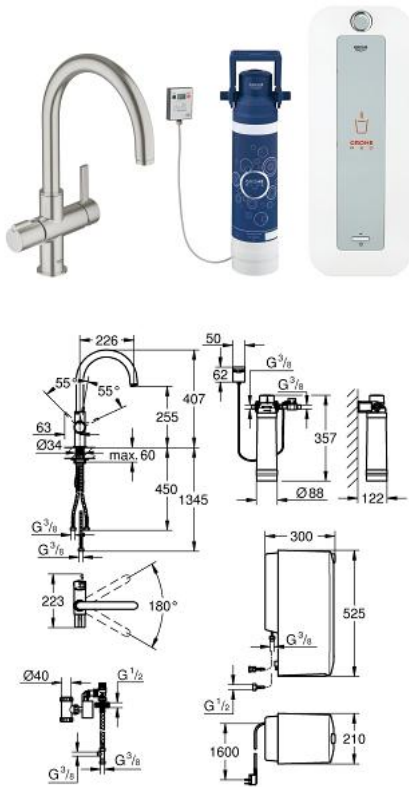

PRODUCT DESCRIPTION

- Colour: supersteel
- consisting of:
 - GROHE Red Duo single-lever sink mixer
 - single hole installation
 - C-spout
 - GROHE ChildLock handle for boiling water
 - certified safety handle with a pull and turn closure
 - headpart 1/2"
 - GROHE SilkMove 35 mm ceramic cartridge
 - GROHE Long-Life finish
 - GROHE CoolTouch
 - swivel, insulated tubular spout
 - separate water ways
 - swivel area 180°
 - protected against backflow
 - flexible connection hoses
 - connection to GROHE Red boiler
 - GROHE Red combi boiler
 - reservoir for boiling and hot water
 - 6 liter boiling water 100° C or 11 liter hot water 55° C
 - with thermostat
 - adjustable from 35° - 75° C
 - with flexible connection hoses and connection thread for boiling water
 - pressure: 1-7 bar
 - CE approved
 - power supply 230 V 50 Hz 30
 - max. power consumption 2100 W
 - standby power consumption 15 W
 - dimensions boiler: 525 x 210 x 300 mm
 - Energy efficiency class water heater: B

30 039 DC0 GROHE RED DUO FAUCET AND COMBI-BOILER (8 LITER)

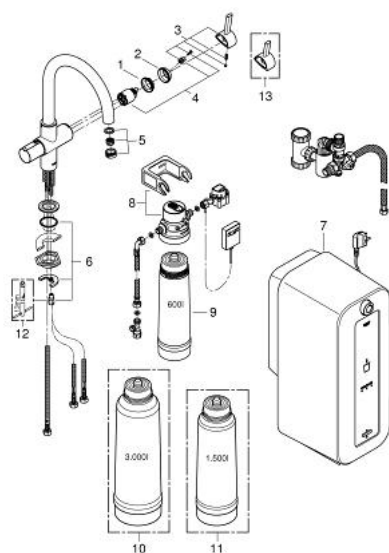

SPARE PARTS, April 2014 – now

- 1: Screw coupling (Order-nr. 46460000)
- 2: Cap (Order-nr. 46116DC0)
- 3: Lever (Order-nr. 46653DC0)
- 4: Cartridge (Order-nr. 46374000)
- 5: Mousseur (Order-nr. 13263DC0)
- 6: Shank mounting kit (Order-nr. 46249000)
- 7: Combi boiler (EU) (Order-nr. 40416000)
- 8: Filter head (Order-nr. 64508001)
- 9: Filter S-Size (Order-nr. 40404001)
- 10: Filter L-Size (Order-nr. 40412001)*
- 11: Filter M-Size (Order-nr. 40430001)*
- 12: Mounting wrench (Order-nr. 19017000)*
- 13: Shorter mixed water lever (Order-nr. 40621000)*

*Special accessories