

30 982 000 **PILLAR TAP 1/2"**

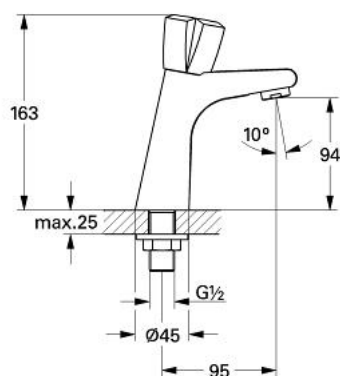

**PRODUCT DESCRIPTION**

- Colour: chrome
- Trecorn handle
- chrome plated plastic
- heat-insulated, screwed union
- marking: blue/red
- economy mousseur
- high version
- GROHE Long-Life finish



30 982 000 **PILLAR TAP 1/2"**

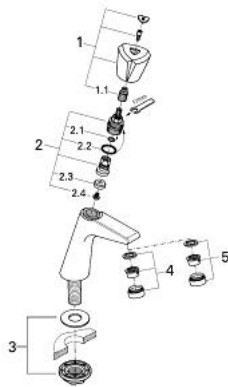

**SPARE PARTS**, January 1993 – now

- 1: ABS handle (Order-nr. 45144000)
- 1.1: Snap insert (Order-nr. 0538600M)
- 2: Headpart 1/2" (Order-nr. 07146000)
- 2.1: Sealing washer Ø 6 x Ø 2 (Order-nr. 0128300M)
- 2.2: O-ring Ø 18.2 x Ø 1.7 (Order-nr. 0392400M)
- 2.3: Seal (Order-nr. 0529100M)
- 2.4: Seal (Order-nr. 0529100M)
- 3: Shank mounting kit (Order-nr. 45004000)
- 4: Mousseur (Order-nr. 13929000)
- 5: Sistra (Order-nr. 13905000)