

31 032 BK0 GROHE F1 THREE-HOLE BASIN MIXER

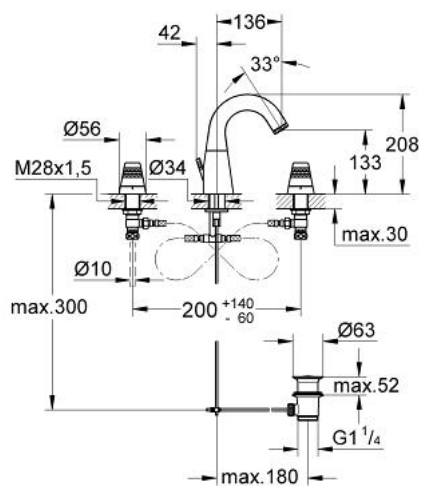

PRODUCT DESCRIPTION

- with cone handle
- non swivel spout with mousseur
- side valves with 1/2" ceramic headparts
- 180° angle
- right-closing
- pressure-proof, flexible connection hoses
- pop-up waste set 1 1/4"
- level regulation for handle gap setting



31 032 BK0 GROHE F1 THREE-HOLE BASIN MIXER

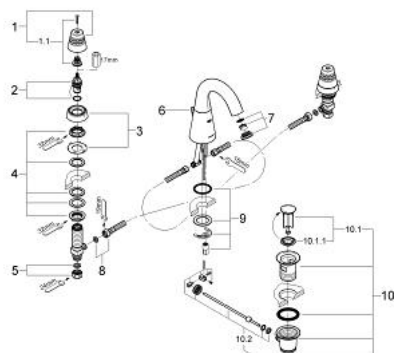

SPARE PARTS, January 2003 – now

- 1: Handle (Order-nr. 45007BK0)
- 1.1: Replacement handle connection kit (Order-nr. 45011000)
- 2: Ceramic headpart 1/2" (Order-nr. 45346000)
- 3: Escutcheon (Order-nr. 45015BK0)
- 4: Counter screws M28 x 1.5 (Order-nr. 45025000)
- 5: Coupling nut 1/2" (Order-nr. 1290100M)
- 6: Pop-up rod (Order-nr. 45089BK0)
- 7: Mousseur (Order-nr. 45090BK0)
- 8: Flexible hose (Order-nr. 45442000)
- 9: Shank mounting kit (Order-nr. 46249000)
- 10: Waste set 1 1/4" (Order-nr. 28910BK0)
- 10.1: Plug (Order-nr. 07182BK0)
- 10.1.1: Seal (Order-nr. 0506500M)
- 10.2: Eccentric rod (Order-nr. 07052000)