

31 640 AT0 **K400 COMPOSITE SINK WITH DRAINER**

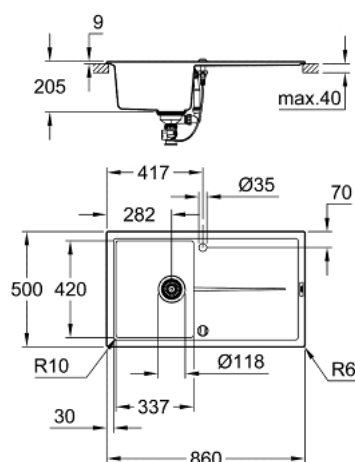

PRODUCT DESCRIPTION

- Colour: granite gray
- model: K400 50-C 86/50 1.0 rev
- mounting type: top mount
- material: quartz composite
- GROHE Whisper
- min. cabinet size: 500 mm
- dimensions: 860 x 500 mm
- 1 bowl: 337 x 420 x 205 mm
- outer radius: R6, inner bowl radius: R10
- GROHE FastFixation installation system
- sink mountable left or right
- cut-out: 840 x 480 mm
- drainer: automatic waste fitting
- accessories included: automatic waste fitting with rotary handle, waste kit, basket strainer waste, mounting set
- optional push to open excenter (40 986 SD0)
- amount of fasteners included (top mount): 10
- heat resistant up to 180° C

31 640 AT0 **K400 COMPOSITE SINK WITH DRAINER**

SPARE PARTS, May 2022 – now

1: Plug (Order-nr. 42588SD1)

2: Siphon (Order-nr. 42617000)

3: Cover element (Order-nr. 42590SD1)

4: Turning handle (Order-nr. 42587SD0)

