

31 819 001 **COSTA S SINGLE-HOLE SINK MIXER 1/2"**

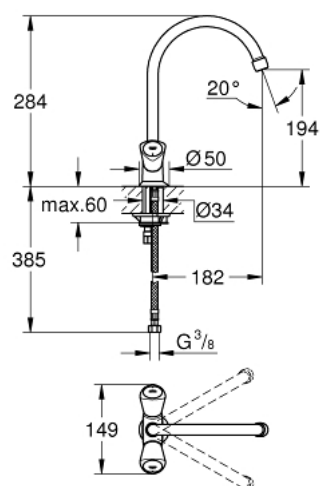

PRODUCT DESCRIPTION

- Colour: chrome
- metal handles
- heat insulated
- screwable
- GROHE Long-Life finish
- Carbidur headparts
- mousseur
- swivel tubular spout
- swivel area 360°
- flexible connection hoses
- maximum flow rate (at 3 bar): 13 l/min



31 819 001 **COSTA S SINGLE-HOLE SINK MIXER 1/2"**

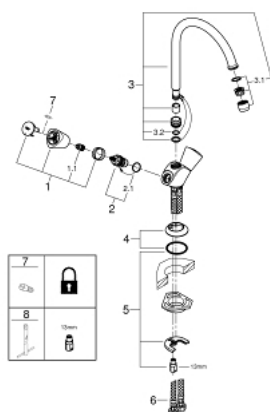

SPARE PARTS, September 2016 – now

- 1: Handle (Order-nr. 45995000)
- 1.1: Snap insert (Order-nr. 0538600M)
- 2: Ceramic headpart 1/2" (Order-nr. 45346000)
- 2.1: O-ring Ø 18.2 x Ø 1.7 (Order-nr. 0392400M)
- 3: Spout (Order-nr. 13213000)
- 3.1: Mousseur (Order-nr. 13928000)
- 3.2: O-ring Ø 12 x Ø 2 (Order-nr. 0128000M)
- 4: Escutcheon (Order-nr. 45996000)
- 5: Shank mounting kit (Order-nr. 46249000)
- 6: Connection hose (Order-nr. 46255000)
- 7: Screw for Costa/Avina products (Order-nr. 48013000)*
- 8: Mounting wrench (Order-nr. 19017000)*

*Special accessories