

33 555 001 EUROSMART SINGLE-LEVER SHOWER MIXER 1/2"



PRODUCT DESCRIPTION

- Colour: chrome
- wall mounted
- metal lever
- GROHE SilkMove 46 mm ceramic cartridge
- GROHE Long-Life finish
- adjustable flow rate limiter
- adjustable minimum flow rate approx. 2.5 l/min
- shower bottom outlet 1/2" with integrated non return valve
- S-unions
- metal wall escutcheons
- optional temperature limiter ref. no. 46 308
- protected against backflow
- noise classification I in accordance with DIN 4109



33 555 001 EUROSMART SINGLE-LEVER SHOWER MIXER 1/2"

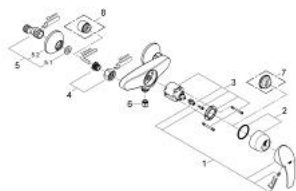

SPARE PARTS, May 2009 – now

- 1: Lever (Order-nr. 46561000)
- 2: Cap (Order-nr. 46243000)
- 3: Cartridge (Order-nr. 46048000)
- 4: Screw connection 1/2" (Order-nr. 45044000)
- 5: S-union (Order-nr. 12075000)
- 5.1: Seal (Order-nr. 0138600M)
- 5.2: Escutcheon (Order-nr. 0221000M)
- 6: Non-return valve (Order-nr. 08565000)
- 7: Temperature limiter (Order-nr. 46308000)*
- 8: Extension 3/4", 20 mm (Order-nr. 0713000M)*

*Special accessories