

## 33 863 LG0 EUROPLUS SINGLE-LEVER SINK MIXER 1/2"

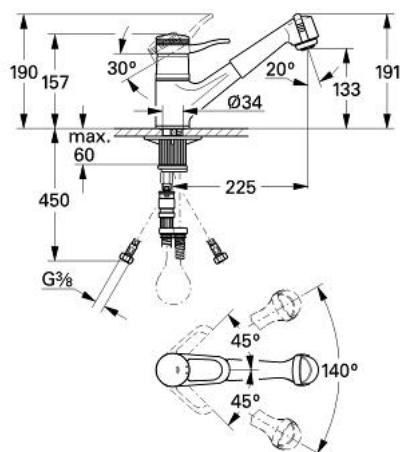

### PRODUCT DESCRIPTION

- single hole installation
- GROHE SilkMove 46 mm ceramic cartridge
- swivel cast spout with stop limiter
- extractable pull out handspray integrated
- automatic returning
- automatic diverter:
- mousseur/hand shower
- flexible connection hoses
- rapid installation system
- optional temperature limiter ref. no. 46 308
- GROHE Long-Life finish

## 33 863 LG0 EUROPLUS SINGLE-LEVER SINK MIXER 1/2"

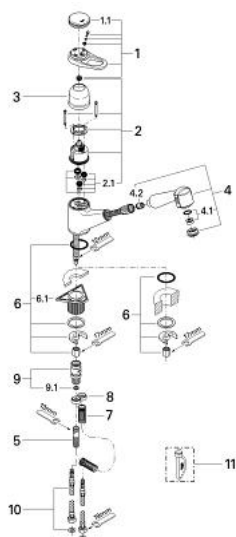

### SPARE PARTS, January 1987 – now

- 1: Lever (Order-nr. 46129LG0)
- 1.1: Cover cap (Order-nr. 46130LG0)
- 2: Cartridge (Order-nr. 46048000)
- 2.1: Seal kit (Order-nr. 46209000)
- 3: Cap (Order-nr. 01734L00)
- 4: Pull out spray (Order-nr. 46252LG0)
- 4.1: Replacement flow control M22x1 and M24x1 (Order-nr. 45002000)
- 4.2: Non-return valve (Order-nr. 08565000)
- 5: Metal hose (Order-nr. 46092000)
- 6: Shank mounting kit (Order-nr. 46346000)
- 6.1: Stop (Order-nr. 04174000)
- 7: Compression spring (Order-nr. 07240000)
- 8: Temperature limiter (when 46 048 until '96) (Order-nr. 46153000)\*
- 8: Temperature limiter (Order-nr. 46308000)\*
- 9: Connection hose, 300 mm (Order-nr. 45120000)\*

\*Special accessories