

## 34 333 000 **PRECISION JOY THERMOSTATIC SHOWER MIXER 1/2"**

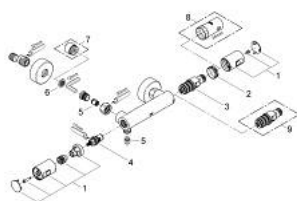

### **SPARE PARTS**, August 2009 – now

- 1: Handle (Order-nr. 47728000)
- 1.1: Cover cap (Order-nr. 6458500M)
- 2: Fitting ring (Order-nr. 47743000)
- 3: Thermostatic compact cartridge 1/2" (Order-nr. 47439000)
- 4: Ceramic headpart 1/2" (Order-nr. 45346000)
- 5: Non-return valve (Order-nr. 08565000)
- 6: Dirt strainer (Order-nr. 0726400M)
- 7: Extension 3/4", 20 mm (Order-nr. 0713000M)\*
- 8: Socket spanner (Order-nr. 19332000)\*
- 9: GROHE TurboStat cartridge 1/2" (Order-nr. 47175000)\*

\*Special accessories