

34 336 000 GROHTHERM 1000 THERMOSTATIC BATH MIXER 1/2"

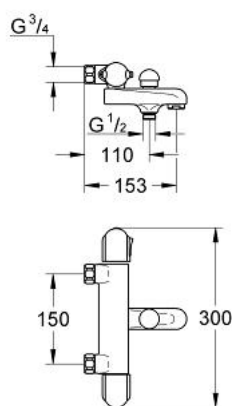

PRODUCT DESCRIPTION

- Colour: chrome
- wall mounted
- wax thermoelement
- integrated mixed water shut off
- Carbodur ceramic headpart 1/2", 180°
- lockable automatic diverter: bath/shower
- mousseur
- temperature scale handle with GROHE SafeStop at 38°C (calibration required)
- shower bottom outlet 1/2"
- built-in non return valves
- dirt strainers
- without connection unions
- GROHE Long-Life finish

34 336 000 GROHTHERM 1000 THERMOSTATIC BATH MIXER 1/2"

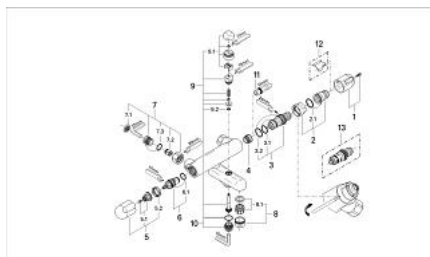

SPARE PARTS, January 1994 – now

- 1: Temperature scale handle (Order-nr. 47352000)
- 2: Stop ring + regulating nut (Order-nr. 47167000)
- 2.1: Sealing washer Ø 24 x Ø 2 (Order-nr. 0119600M)
- 3: Thermo-element 1/2" (Order-nr. 47450000)
- 3.1: Sealing washer Ø 21 x Ø 2 (Order-nr. 0599900M)
- 3.2: Sealing washer Ø 24 x Ø 2 (Order-nr. 0119600M)
- 4: Seat for thermostat (Order-nr. 02307000)
- 5: Handle for shut-off valve (Order-nr. 47092000)
- 5.1: Replacement handle connection kit (Order-nr. 45186000)
- 5.1.1: O-ring Ø 18.2 x Ø 1.7 (Order-nr. 0392400M)
- 5.2: Support ring (Order-nr. 03070000)
- 6: Ceramic headpart 1/2" (Order-nr. 45346000)
- 6.1: O-ring Ø 18.2 x Ø 1.7 (Order-nr. 0392400M)
- 7: Non-return valve (Order-nr. 47189000)
- 7.1: Dirt strainer (Order-nr. 0726400M)
- 7.2: Non-return valve (Order-nr. 08565000)
- 7.3: O-ring Ø 17 x Ø 2 (Order-nr. 0305500M)
- 8: Mousseur (Order-nr. 13927000)
- 8.1: Replacement flow control M28x1 (Order-nr. 45029000)
- 9: Diverter (Order-nr. 47238000)
- 9.1: Diverter knob (Order-nr. 47354000)
- 9.2: Sealing washer Ø 6 x Ø 2 (Order-nr. 0128300M)
- 9.2: O-ring Ø 6 x Ø 2 (Order-nr. 0881100M)
- 10: Shower nipple (Order-nr. 45104000)
- 11: Socket spanner (Order-nr. 19070000)*
- 12: Stop (Order-nr. 05657000)*
- 13: Thermo-element 1/2 for changed waterways (Order-nr. 47282000)*

*Special accessories