

34 686 000 **SENTOSA THERMOSTATIC SHOWER MIXER 1/2"**

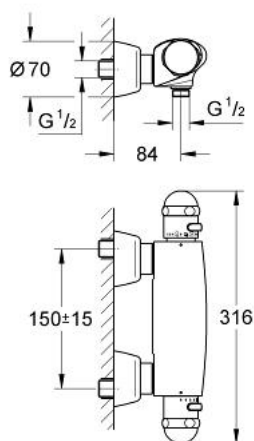

PRODUCT DESCRIPTION

- Colour: chrome
- wall mounted
- wax thermoelement
- integrated mixed water shut off
- Carbodur ceramic headpart 1/2", 180°
- volume handle with economy button
- temperature scale handle with GROHE SafeStop at 38°C
- individual adjustable economy stop
- shower bottom outlet 1/2"
- built-in non return valves
- dirt strainers
- covered S-unions
- protected against backflow
- without shower set
- GROHE Long-Life finish

34 686 000 **SENTOSA THERMOSTATIC SHOWER MIXER 1/2"**

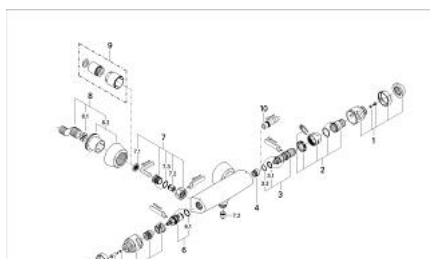

SPARE PARTS, January 1998 – now

- 1: Temperature scale handle (Order-nr. 47422IP0)
- 2: Regulating nut + stop ring (Order-nr. 47441000)
- 3: Thermo-element 3/8" (Order-nr. 47349000)
- 3.1: O-ring $\varnothing 15 \times \varnothing 2.5$ (Order-nr. 0012300M)
- 3.2: O-ring $\varnothing 16 \times \varnothing 1.25$ (Order-nr. 0122500M)
- 4: Seat for thermostat (Order-nr. 02406000)
- 5: Handle for shut-off valve (Order-nr. 47423IP0)
- 6: Ceramic headpart 1/2" (Order-nr. 45346000)
- 6.1: O-ring $\varnothing 18.2 \times \varnothing 1.7$ (Order-nr. 0392400M)
- 7: Non-return valve (Order-nr. 47189000)
- 7.1: Dirt strainer (Order-nr. 0726400M)
- 7.2: Non-return valve (Order-nr. 08565000)
- 7.3: O-ring $\varnothing 17 \times \varnothing 2$ (Order-nr. 0305500M)
- 8: S-union (Order-nr. 12058000)
- 8.1: Seal (Order-nr. 0138600M)
- 8.2: Covering escutcheon (Order-nr. 45545000)
- 9: Extension set, 30 mm (Order-nr. 46238000)*
- 10: Socket spanner (Order-nr. 19070000)*

*Special accessories