

36 016 001 EUROPLUS E INFRA-RED ELECTRONIC BASIN TAP 1/2" WITHOUT MIXING DEVICE

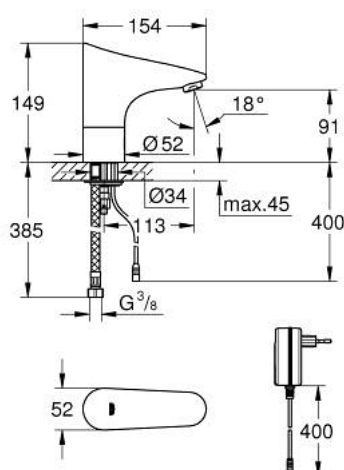

PRODUCT DESCRIPTION

- Colour: chrome
- with infrared sensor for bi-directional communication for monitoring, configuration and servicing
- for cold or premixed water
- with plug transformer 100-230 V AC, 50-60 Hz, 6 V DC
- GROHE Water Saving - Less water, perfect flow
- maximum flow rate (at 3 bar): 5 l/min
- flexible connection hoses
- dirt strainer
- solenoid valve
- rapid installation system
- 7 pre-set programs:
 - auto flush
 - thermal disinfection
 - cleaning mode
- additional functions and precise settings by remote control 36 407
- CE approved
- noise classification I in accordance with DIN 4109
- type of protection faucet IP 59K

36 016 001 EUROPLUS E INFRA-RED ELECTRONIC BASIN TAP 1/2" WITHOUT MIXING DEVICE

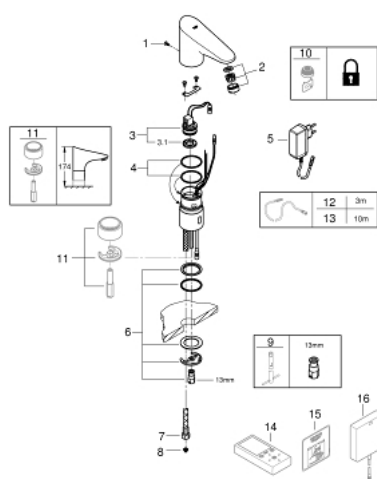

SPARE PARTS, August 2016 – now

- 1: Screws (Order-nr. 4283100M)
- 2: Mousseur (Order-nr. 48159000)
- 3: Solenoid valve (Order-nr. 42229000)
- 3.1: Dirt strainer (Order-nr. 42798000)
- 4: Sealing washer (Order-nr. 4283600M)
- 5: Mains adaptor (Order-nr. 42388000)
- 6: Fixing set (Order-nr. 42841000)
- 7: Connection hose (Order-nr. 46255000)
- 8: Dirt strainer (Order-nr. 4215200M)
- 9: Mounting wrench (Order-nr. 19017000)*
- 10: Mousseur (Order-nr. 36133000)*
- 11: Socket (Order-nr. 36210000)*
- 12: Power extension cable (Order-nr. 36340000)*
- 13: Power extension cable (Order-nr. 36341000)*
- 14: Remote control (Order-nr. 36407001)*
- 15: Sticker with pictograph (Order-nr. 4217700M)*
- 16: Switch-mode power supply (Order-nr. 36338000)*

*Special accessories