

## 36 315 000 EUROSMART COSMOPOLITAN E INFRA-RED ELECTRONIC BASIN MIXER WITH MIXING DEVICE AND ADJUSTABLE TEMPERATURE LIMITER

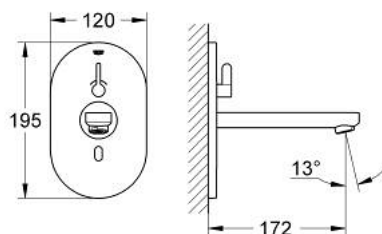

### PRODUCT DESCRIPTION

- Colour: chrome
- with infrared sensor for bi-directional communication for monitoring, configuration and servicing
- with transformer 100-230 V AC, 50-60 Hz, 6 V DC
- maximum flow rate (at 3 bar): 8 l/min
- laminar flow straightener
- chrome escutcheon
- chrome spout
- projection 170 mm
- 7 pre-set programs:
  - auto flush
  - thermal disinfection
  - cleaning mode
- additional functions and precise settings by remote control 36 407
- set for final installation for concealed fitting box
- 36 339 001
- CE approved
- noise classification I in accordance with DIN 4109

## 36 315 000 EUROSMART COSMOPOLITAN E INFRA-RED ELECTRONIC BASIN MIXER WITH MIXING DEVICE AND ADJUSTABLE TEMPERATURE LIMITER

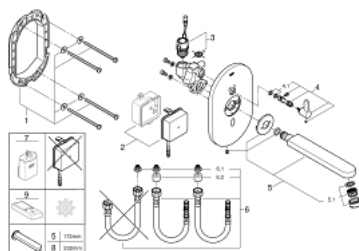

### SPARE PARTS, October 2018 – now

- 1: Mounting frame (Order-nr. 42419000)
- 2: Switching power supply (Order-nr. 42470000)
- 3: Solenoid valve (Order-nr. 42469000)
- 4: Mixing lever (Order-nr. 42441000)
- 4.1: Sealing washer (Order-nr. 4284000M)
- 5: Spout (Order-nr. 42420000)
- 5.1: Economy mousseur (Order-nr. 13951000)
- 5.1: Laminar flow straightener (Order-nr. 13960000)
- 6: Connection hose set (Order-nr. 42417000)
- 6.1: Filter (Order-nr. 4241300M)
- 6.2: Non-return valve (Order-nr. 4240400M)
- 7: Battery housing (Order-nr. 42393000)\*
- 8: Spout (Order-nr. 42418000)\*
- 9: Remote control (Order-nr. 36407001)\*

\*Special accessories