

- Colour: chrome
- with infrared sensor for bi-directional communication for monitoring, configuration and servicing
- 6 V lithium battery, type CR-P2
- battery lifetime: approx. 7 years (150 actuations a day)
- GROHE Water Saving - Less water, perfect flow
- maximum flow rate (at 3 bar): 5 l/min
- pop-up waste set 1 1/4"
- non return valve
- dirt strainers
- with integrated solenoid valve
- external battery
- rapid installation system
- multistage battery status display
- 7 pre-set programs:
- auto flush
- thermal disinfection
- cleaning mode
- additional functions and precise settings by remote control 36 407
- CE approved
- noise classification I in accordance with DIN 4109
- type of protection faucet IP 59K
- min. recommended pressure 1.0 bar

36 331 001 EUROSMART COSMOPOLITAN E INFRA-RED ELECTRONIC BASIN MIXER WITH MIXING DEVICE AND ADJUSTABLE TEMPERATURE LIMITER

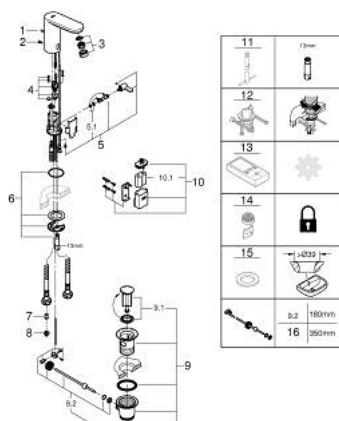

SPARE PARTS, March 2021 – now

- 1: Pop-up rod (Order-nr. 46739000)
- 2: Screws (Order-nr. 4283100M)
- 3: Mousseur (Order-nr. 48159000)
- 4: Solenoid valve (Order-nr. 42479000)
- 5: Mixing lever (Order-nr. 42401000)
- 5.1: Sealing washer (Order-nr. 4284000M)
- 6: Mounting set (Order-nr. 42400000)
- 7: Non-return valve (Order-nr. 4257200M)
- 8: Filter (Order-nr. 4241300M)
- 9: Waste set 1 1/4" (Order-nr. 28910000)
- 9.1: Plug (Order-nr. 07182000)
- 9.2: Eccentric rod (Order-nr. 07052000)
- 10: Battery housing (Order-nr. 42393000)
- 10.1: Battery (Order-nr. 42886000)
- 11: Mounting wrench (Order-nr. 19017000)*
- 12: Rotation lock (Order-nr. 36276000)*
- 13: Remote control (Order-nr. 36407001)*
- 14: Mousseur (Order-nr. 36133000)*
- 15: Hidden mixing device (Order-nr. 42408000)*
- 16: Escutcheon (Order-nr. 36370000)*
- 17: Eccentric rod (Order-nr. 07341000)*

*Special accessories