

37 751 000 TECTRON RETROFIT UNIT

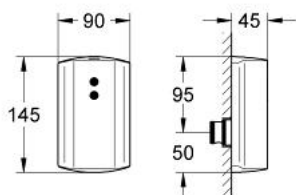

PRODUCT DESCRIPTION

- Colour: chrome
- exposed installation
- for concealed urinal flush valve 37 017 and DAL 509
- CE approved
- metal housing 145 x 90 x 45 mm
- 6 V DC battery supply
- infra-red electronic with battery LED
- adjustable flow time
- 24 h flushing can be activated
- solenoid valve with dirt strainer
- GROHE Water Saving - Less water, perfect flow
- GROHE Long-Life finish



37 751 000 TECTRON RETROFIT UNIT

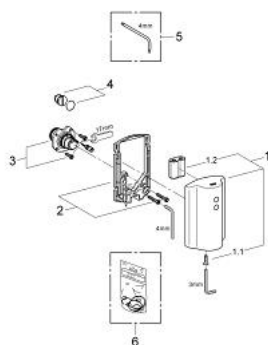

SPARE PARTS, January 1999 – now

- 1: Housing electronic for 37 751 (Order-nr. 42789000)
- 1.1: Fastening screw for 37751 (Order-nr. 42788000)
- 1.2: Battery (Order-nr. 42886000)
- 2: Mounting frame for 37751 (Order-nr. 42790000)
- 3: Solenoid valve with strainer for 37 751 (Order-nr. 42791000)
- 4: Supply stop (Order-nr. 43392000)
- 5: Triangular Allen key (Order-nr. 43784000)*
- 6: Set of seals for 37 751 (Order-nr. 42792000)*

*Special accessories